

Portixol
Объект № 120064С



PORTA MALLORQUINA®
Your home. Our passion.

Innovative luxury penthouse with private roof terrace in Nou Llevant

жилая площадь: 194 m²
спальни: 2
санузел: 2
балкон или
терраса: -
вид на море:

бассейн: ✓
Энергетическая
сертификация: в процессе

цена: € 2.200.000,-



Portixol

Объект № 120064C



Описание объекта:

In Nou Llevant, near Portixol, overlooking the lively and elegant neighborhood and within walking distance of the port, a unique and spectacular construction project with 65 units is currently under construction. Here, people who love the extraordinary will find a home that is impressive in many ways. Each apartment in this project is absolutely unique and impresses with the highest construction quality, innovative design, modern technology and forward-looking sustainability.

This project focuses on the development of holistic, future-oriented and innovative living concepts that are special due to their architecture and design. Unique floor plans are created by integrating current design trends and the highest quality materials.

The penthouse is located on the fourth floor extends over a generous constructed area of 193.70 sqm and offers 2 bedrooms, 2 of which are en suite. An absolute highlight is the private terrace with a generous area of 99.38 sqm, which offers you plenty of space to relax and enjoy.

There are 3 lines of equipment of the highest quality to choose from, providing an incomparable living experience. With customized upgrade packages, the apartments can be adapted to the needs of the residents.

Extra features include air conditioning, underfloor heating, blinds and motorized windows, smart home, CCTV - CCTV system, energy efficient lighting and underground parking with e-charging point.

The community area includes a lounge, infinity pool, gym, spa rooms, concierge service, cinema room and golf simulator.

Portixol

Объект № 120064C



Месторасположения и окрестности:

Portixol/Molinar is one of Palma's loveliest and most popular zones, both as a holiday destination and for real estate buyers.

Portixol is an old fishing harbour which has become one of the most popular areas of Palma, and its name means 'Harbour and Sun' in Mallorquin. It has excellent fish restaurants, great tapas bars and diverse cafes filled with life all year round and leaving no gastronomical wishes unfulfilled. Many are situated right on the sea with views of the small beach and the Club Nautic in Portixol. Sports enthusiasts such as cyclists, inline-skaters and walkers love the Paseo Maritimo which leads to Palma without gaps or interruptions, and the zone is completed by its many and varied shops and supermarkets and the large, modern sports centre.

Beach fans will also feel at home in the district of Portixol/Molinar. Both on Palma's town-beach Portixol with its very clean water but also in the small charming bays which can be found on the way from Molinar to Palma.

Portixol

Объект № 120064С



All information is correct to the best of our knowledge. Errors and prior sale excepted. This prospectus is purely for information purposes. Only the notarized deed of sale is legally binding.

PORTA MALLORQUINA • THERESIENST.: 81, D-80333 MÜNCHEN
TEL. +34 971 698 242 • INFO@PORTAMALLORQUINA.COM

Portixol

Объект № 120064С

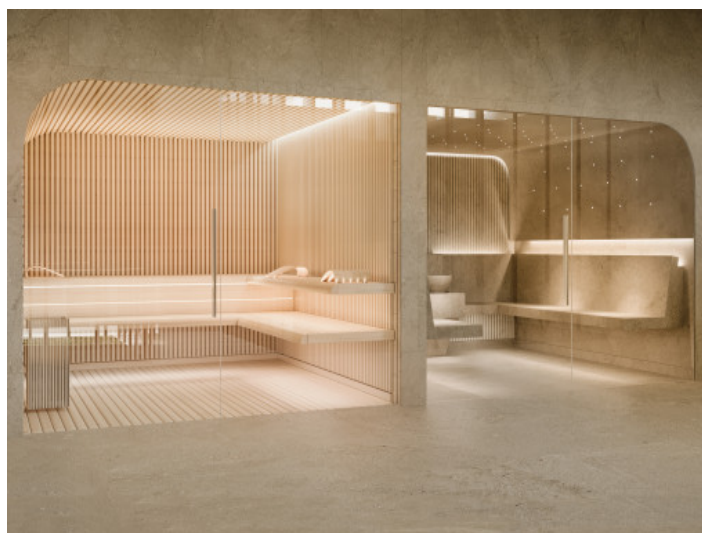

All information is correct to the best of our knowledge. Errors and prior sale excepted. This prospectus is purely for information purposes. Only the notarized deed of sale is legally binding.

PORTA MALLORQUINA • THERESIENST.: 81, D-80333 MÜNCHEN
TEL. +34 971 698 242 • INFO@PORTAMALLORQUINA.COM

Объект № 120064С



PORTA MALLORQUINA • THERESIENST.: 81, D-80333 MÜNCHEN
TEL. +34 971 698 242 • INFO@PORTAMALLORQUINA.COM